

# DATA COLLECTOR

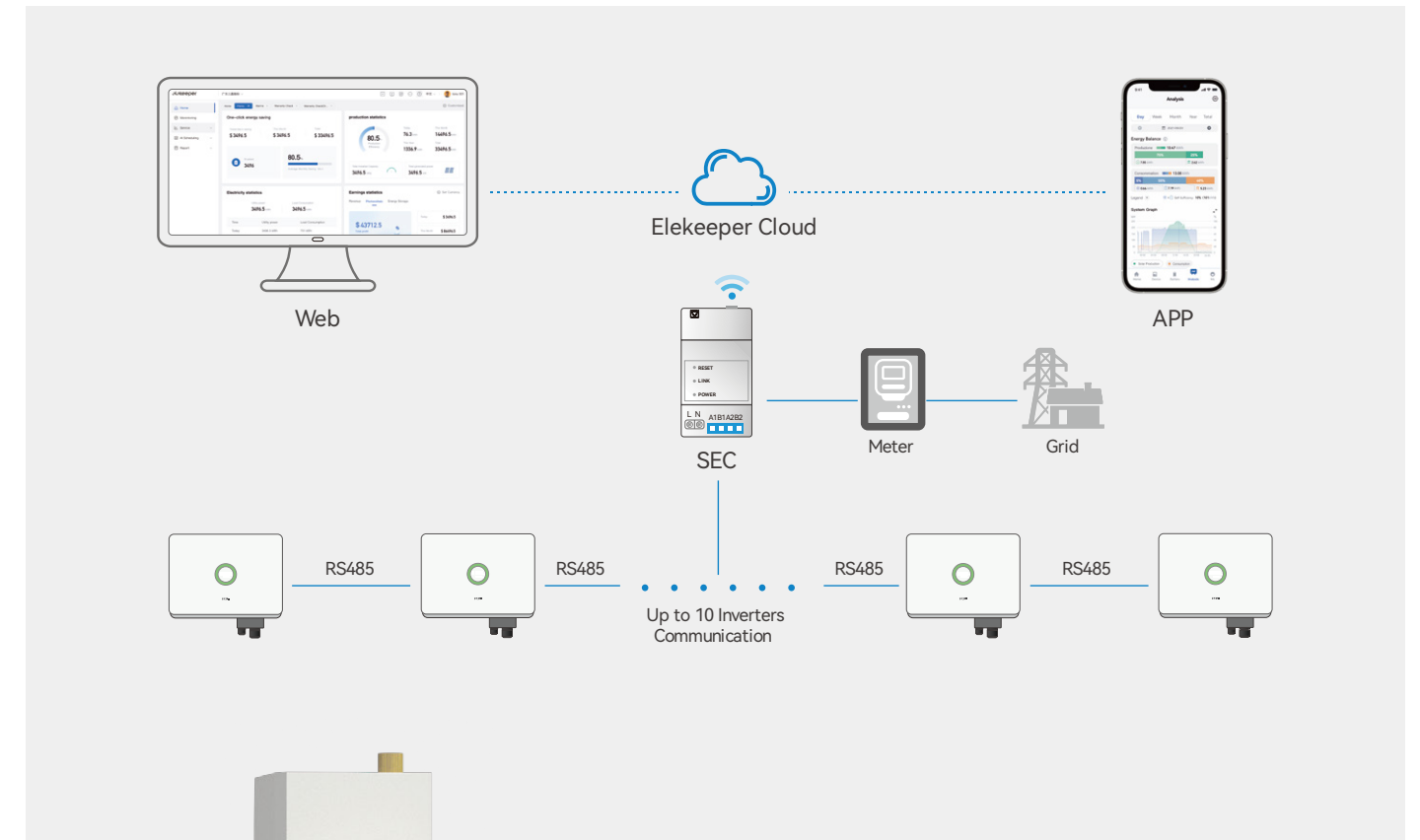

eSolar AIO3 | eSolar WiFi-D  
eSolar 4G | eSolar GPRS

MODEL	eSolar AIO3	eSolar WiFi-D	eSolar 4G	eSolar GPRS (R5 Only)
<b>General Parameters</b>				
Connecting Inverters No. [Pcs]	1			
Inverter Communication Port	USB			
Communication	Wi-Fi/Ethernet/Bluetooth	Wi-Fi	4G/Bluetooth	GPRS/Bluetooth
Operating Frequency	2.4Ghz	2.4Ghz	LTE-TDD, LTE-FDD	850/900/1800/1900Mhz
Data Collection Interval [min]	0.5~30 [Optional], 5 [Standard]	1~30 [Optional], 10 [Standard]		
Firmware Update Method	Serial Port/ Remote			
Access Data Method	Integrated Webpage/ Remote Sever			
Display	OLED+LED	OLED+LED	LED	LED
<b>Electrical Parameters</b>				
Input Voltage	DC 5~7V (±5%)			
Static Consumption [W]	<0.3	<1	<0.25	<0.25
Max. Instant Consumption [W]	<8	<8	<18	<15
<b>Environment</b>				
Operating Temperature Range	-40°C~+60°C	-40°C~+85°C	-25°C~+75°C	-25°C~+75°C
Storage Temperature Range	-45°C~+70°C	-45°C~+90°C	-40°C~+90°C	-40°C~+90°C
Dimensions [H*W*D][mm]	145*50*41	125*50*41	125*53*31	125*53*31
Weight [g]	100	80	87	87
Ingress Protection	IP65			
<b>Others</b>				
Mounting Method	Plug-in + Screw Lock			
Warranty [Year]	2			



eSolar SEC

MODEL	eSolar SEC-C/eSolar SEC-S
<b>General Parameters</b>	
Application	Commercial Projects Monitoring
Max. No. of Connected Devices [Pcs]	10
Communication	Wi-Fi/ Ethernet/ Bluetooth/ RS485
Data Collection Interval [min]	1~30 [Optional], 10 [Standard]
Firmware Update Method	Serial Port / Remote
Data Access Method	APP/ Web/ Sever
Display	LED
<b>Electrical Parameters</b>	
Input Voltage	100~240Vac
Input Frequency	50/60Hz
Static Power [W]	<0.8
Max. Instantaneous Power [W]	<5
<b>General Data</b>	
Operating Temperature Range	-25°C~+60°C
Storage Temperature Range	-40°C~+85°C
Dimensions [H*W*D][mm]	84.4*36*65.5
Weight [g]	100
Ingress Protection	IP20
<b>Others</b>	
Mounting	Rail
Warranty [year]	2
Certification	CE RoHS